

# Mechanical Sidewinder™ Benders

A fully portable system that bends:

- ½" to 1½" rigid steel, rigid aluminum, PVC-Coated rigid and IMC conduit.
- ½" to 2" EMT conduit.
- Removable bender can be bolted onto workbench or truck bed for unparalleled flexibility.
- 0° to 90° bend indicator built into the frame shows bend angle while bending.
- Double-dog ratchet prevents shoe spring-back during bends; allows fast release after bending.
- Interchangeable shoes adapt single bender frame to cover widest range of conduit types.

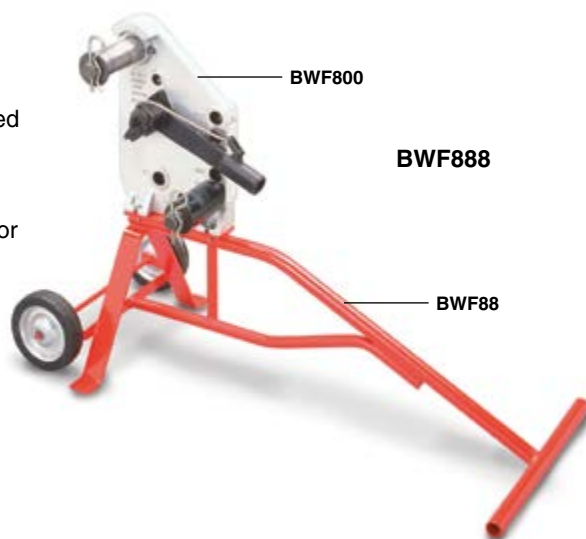

## BWF800 Bender Head Assembly

Part #	Description	Weight
<b>BWF888</b>	Sidewinder™ Bender w/ out Shoe Groups	64 lbs
<b>BF41</b>	Urethane Roller Assembly & Shaft Assembly	3 lbs
<b>BF42</b>	2" EMT Strap	8 lbs
<b>BF47</b>	Shaft Assembly	3 lbs
<b>BF48</b>	2" Steel Sleeve and Strap Kit	4 lbs
<b>BF49</b>	Ratchet Assembly	9 lbs
<b>BT112520</b>	Insert Teeth (for 1¼" - 1½" and 2" shoes)	1 lb
<b>CM260281</b>	Urethane Roller Only	1 lb

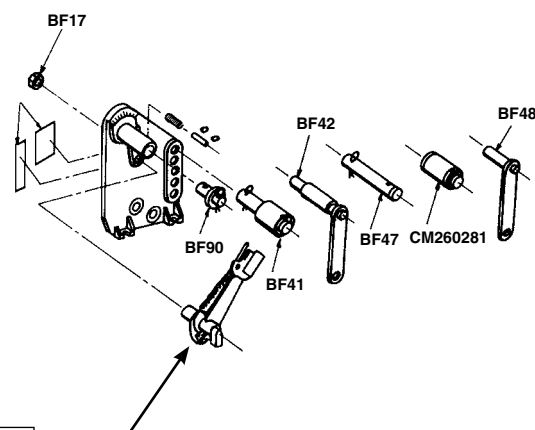

Jaws attach to shoes with chain.

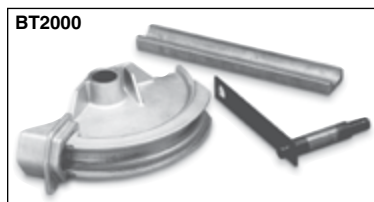

## Repair Kits for BF49

Part #	Description
<b>BW72</b>	Lever and Washer Kit
<b>BW74</b>	Drive Pawl and Spring Kit
<b>BW75</b>	Hold Pawl and Spring Kit
<b>BW76</b>	Pin and Spring Kit

See Repair Parts Sheet for a detailed breakdown of these kits.

**tip:** A bend handle is not included with these units. A 6 ft. piece of 1" Dia. Rigid conduit can be used.

## Bending Shoes

Part #	Clamping Jaw Range	Conduit	Weight	Clamping Jaw Part #	Weight
<b>BT57510</b>	½", ¾" & 1"	EMT	15 lbs	BZ1306	2 lbs
<b>BT12515</b>	1¼" - 1½"	1½" EMT	34 lbs	BZ1307	4 lbs
<b>BT2000*</b>	2"	EMT	39 lbs	BZ13081	4 lbs
<b>BR57510</b>	½", ¾" & 1"	Rigid & IMC	18 lbs	BZ1306	2 lbs
<b>BR12515</b>	1¼" - 1½"	Rigid & IMC	28 lbs	BZ1307	4 lbs
<b>BR20000</b>	2"	Aluminum Rigid	33 lbs	BZ1308	3 lbs

\*Shoe includes BZ1345 follow bar and strap.